

Left of fence, N & S.

Continued on page 148.

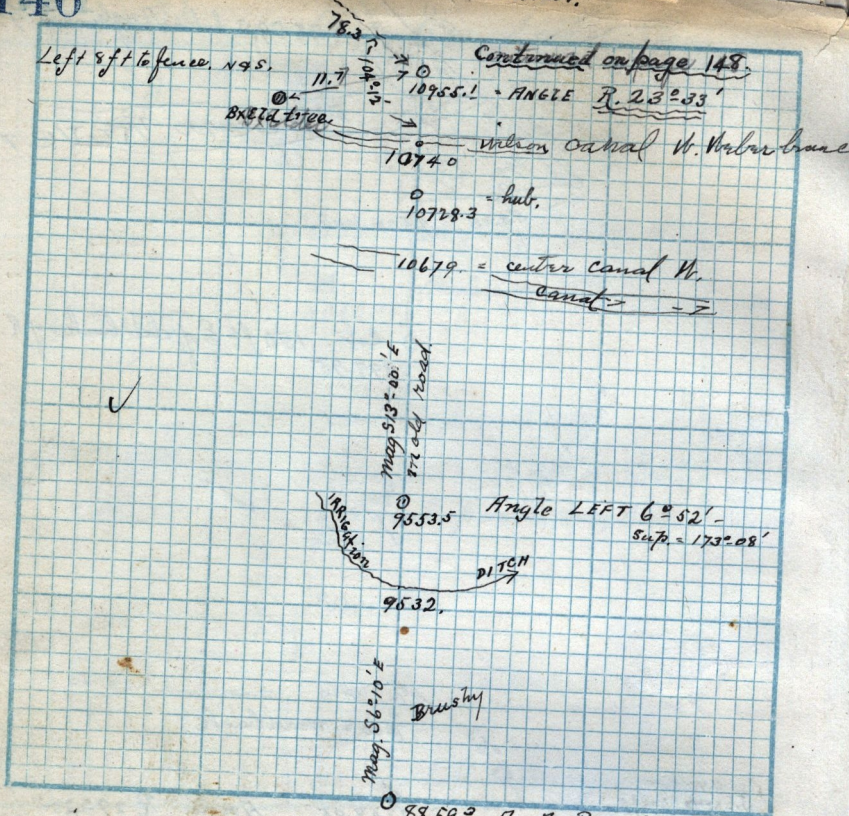

Scale:

Sup 170° 46' 30"  
Chains per inch.

July 28<sup>th</sup> 1890  
Resurvey of the County  
Road from Blufford Baylors  
across the River to the  
Westwater Road.

E. 5.80 ch N 2 1/2° E 3. ch N.W. - W - S.W. down  
Slough to pt N 2 1/2° E 17. ch from leg

August 5 - 1890 - Survey of part of Lot 8 - B-30 - Plat  
A. Ogden lotter Survey for M. V. Gilbert and Valentine Gideon  
Beg. at the N.W. cor. of Lot 8. 5 10. Rods E 4 Rods N 10. Rods W 4 Rods  
to leg. a portion of a house + cornice 4' 6" occupies a part  
of the East side of the said tract.